

Jocavi Group
JOCAVI GROUP®



music accessories



MIC PROTECTOR®

ATP® Studio Line

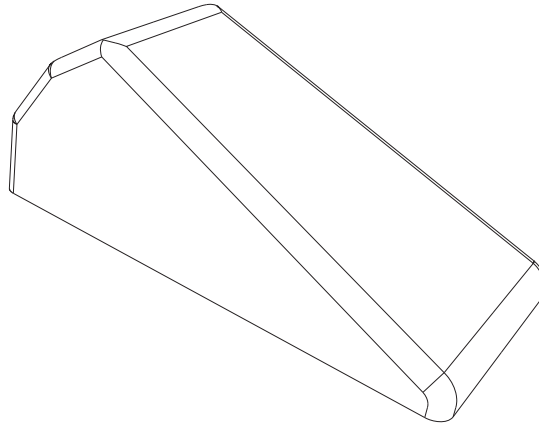

Features:

- * Insulation protector for microphones.
- * Acoustically separates sound capturing.
- * Fits most microphone models.
- * Installation: on a microphone tripod.
- * Packaging: box with 1 or 4 units.
- * Use: at live and in studio.
- * Dimensions: 220 x 110 x 85 mm.
- * Colour: gray, transparent and glossy.

Plastic colours:



This accessory is more useful to sound engineers and technicians than to musicians themselves.

This accessory is original, unique, highly necessary and in high demand. It is often used by sound engineers to improvise and make bricolage, when they need to use

something that produces this insulation effect while capturing several instruments that are close to each other. The MP1® surrounds the microphone individualising the sound that is captured.

Especially at live events, it modifies the insert's behaviour of "noise gates, compressors, dynamics' controllers" and provides them with better autonomy and easiness of control.

It is ideal to use under and over snare drums, as well as floor toms, jazz bass drums, guitar amplifiers, basses and wherever each one's imagination will dictate.

MIC PROTECTOR®



HORNDIFFUSER®

ATP® Studio Line

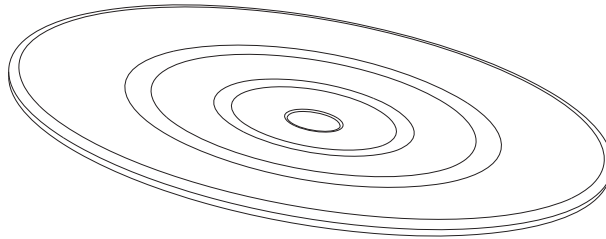

Features:

- * Acoustic reflector for wind instruments.
- * Increases the return of the direct sound back to the musician.
- * Insulates the sound coming from the monitors.
- * Installation: by embedding in the microphone or microphone tripod.
- * Use: at live and in studio.
- * Packaging: 1 unit.
- * Dimensions: diameter 290 mm.
- * Colour: transparent and glossy

Plastic colours:



This accessory works as an acoustic mirror for trumpeters, trombonists and saxophonists.

It is applied around the microphone. It provides the musician with the direct return of the sound that he/she plays.

Besides this important advantage to the musician, it also offers benefits to the sound technician or engineer, since it insulates the microphone from the sound that comes from the stage monitors by creating a sort of a wall behind the microphone.

Its curvature shapes are optimised with the aim of focusing on the musician the reflection of his/her sound in the most efficient way.

HORNDIFFUSER®



POP OFF®

ATP® Studio Line

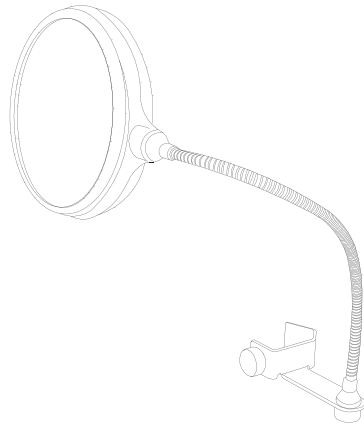

Features:

- * Filter for microphone.
- * Eliminates popping and sibilance.
- * Use: recording and broadcasting studios.
- * Installation: direct fastening to the microphone tripod.
- * Packaging: 1 unit.
- * Dimensions: diameter 165 mm.
- * Colour: black

Colours:



The singers' voice causes a quick displacement of air in some syllables which in turn causes an instantaneous clipping on the microphones' membrane.

The POP OFF® is our professional proposal for a microphone filter. It is made of a permeable nylon canvas to reduce or eliminate the "popping" and "sibilance" effect, like for example when the words "pop stars" are pronounced.

The use of POP OFF® solves this situation, not even being necessary to adjust the pre-amplifier and take therefore dynamics away from sound capturing.

This accessory has a strong flexible arm which is robustly fastened to the microphone's tripod.



VOCAL MIC REFLECTION FILTER®

ATP® Studio Line

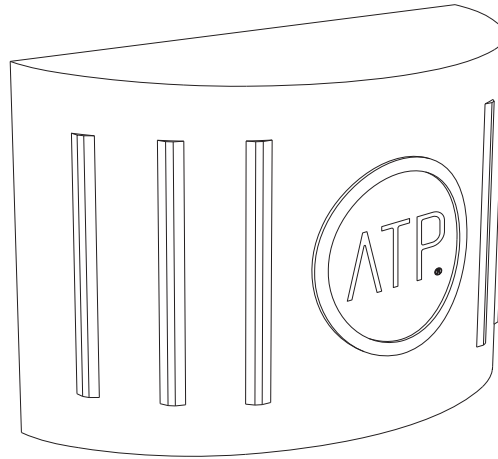

Features:

- * Acoustic bell for microphone.
- * Insulates the microphone from the room effect.
- * Acoustically conditions the microphone.
- * Use: recording and broadcasting studios.
- * Installation: direct fastening to the microphone tripod.
- * Packaging: 1 unit.
- * Dimensions: 580 x 380 x 240 mm.
- * Colour: metallic gray and black.

Plastic colours:



This parabola-shaped accessory is a creativity aid to sound engineers who search for the perfect loudness for each project. It enables significant sound variations by adjusting the position between the piece and the microphone. The bell that defines its shape is sealed, which improves the insulation of the room environment effect. It reduces the amount of energy reflected from the room surfaces, walls, floor and ceiling, thus making the sound of voices or instruments more authentic.

The VMRFilter® is made of four different raw materials with no metal components, thus not causing any change to the magnetic field of microphones. The size and shape of this piece were optimised with the aim to maximise the absorption inside the VMRFilter, in order not to influence the colouring or polarity of each microphone but influence the surrounding acoustics.

The VMRFilter's interior is made of three different permeable absorbent materials which provide it with interesting features. It is a great piece to record singers, broadcasters, acoustic and electric guitars and basses, flutes, wind instruments, etc.. It works even if your room is not duly treated.

It can be mounted on the same tripod of the microphone itself. However, if mounted on a separate tripod, it is easier to tune the VMRFilter's best positioning in relation to the microphone that is being used. It enables therefore several flavours with more or less ambiance, more or less absorption or insulation. Give it a try!

VOCAL MIC REFLECTION FILTER®



SUB WOOFER BASE®

ATP® Speaker Line

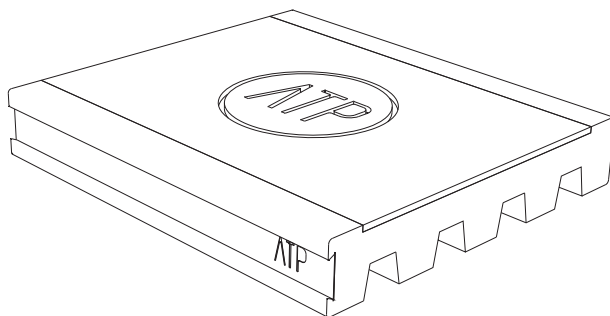

Features:

- * Anti-vibration speaker base.
- * Two sizes available.
- * Use: sub-woofer.
- * Installation: to be placed on the floor.
- * Fits most models.
- * Packaging: 1 unit.
- * Dimensions SWB I: 400 x 400 x 90 mm.
- * Dimensions SWB II: 500 x 580 x 90 mm.
- * Colour: dark gray.

Colours:



The SWB® is a key piece for your set-up when you use a sub-woofer. This accessory is essential and quite inexpensive, and reduces the vibrations that result from the physical propagation to the accessories present in the room.

The top part is stiff and causes a weight distribution across the whole area in contact with the floor.

The sizes are in accordance with most manufacturers of this type of speakers.

There are two different sizes, SBB®1 and SBB®2.





NEAR FIELD BASE®

ATP® Speaker Line

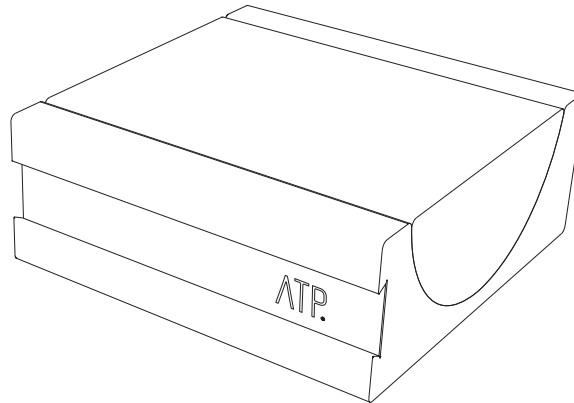

Features:

- * Insulation protector for microphones.
- * Anti-vibration speaker base.
- * Two sizes available.
- * Use: nearfield and midfield speakers.
- * Position adjustment in the vertical angle.
- * Installation: to be placed on working consoles or speaker stands.
- * Fits most models.
- * Packaging: 2 units.
- * Dimensions NFB I : 300 x 300 x 117 mm.
- * Dimensions NFB II : 430 x 430 x 117 mm.
- * Colour: dark gray

Colours:



The NFB® is an essential accessory for your music audition room or studio control room.

This quite inexpensive piece works miracles on your room's sound. It minimizes the propagation of physical vibrations to the pieces installed on the workbenches, which also end up playing and vibrating thus causing spurious noises.

The innovation of the NFB's drawing consists on the possibility of adjusting the vertical angle from the speaker's position to the audition "sweet spot", thus adding one more important benefit to this accessory.

All these benefits will thus allow you to optimise the sound of your room. You can position this piece in relation to the monitors and reduce the unwanted vibrations.

This accessory is meant to be used in "nearfields". The two existing sizes, NFB®1 and NFB®2, adjust to most models of this type of speakers.

NEAR FIELD BASE®



DRUMBASE®

ATP® Drum Kit Line

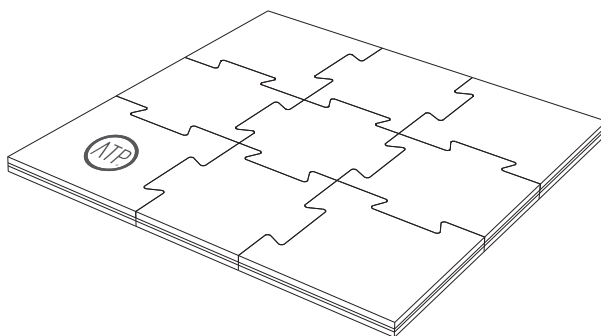

Features:

- * Insulation protector for microphones.
- * Anti-vibration platform.
- * Dimensions: 1970 x 1970 x 27mm.
- * Packaging: 1 kit (9 pieces).
- * Installation: by embedding.
- * Use: at live and in studio.
- * Fits the standard size of stage platforms.
- * Manufactured with 60% recycled material.
- * Provided with carrying-bag.
- * Colour: gray

Colours:



The ATP DRUMBASE® is an anti-vibration platform for drum sets which is composed of 9 pieces that fit together and make up a total area of 4m² (2mt x 2mt).

The material used in its base is non-skid, closed-cell, made of recycled rubber, and its density is duly adjusted. In order to exert the best inertia on the physical propagation of energy, we took into account the weight of both the instrument and the musician, as well as the weight of the reverberated movements that are made when the musician is playing.

It is easily mounted by fitting together the several modules on the floor or the stage. It just takes two minutes for your DRUMBASE® to be ready. The 9 modules fit together in a perfect way, thereby preventing them from getting separated due to oscillations during performance. It has a carpet finishing.

The DRUMBASE® is a great tool to optimise the sound of your drum kit and is excellent to be used at live or in the studio.

We offer a carrying-bag and a pencil to mark the position of the several pieces that lay on the platform.



KICK PAD® Kit

ATP® Drum Kit Line

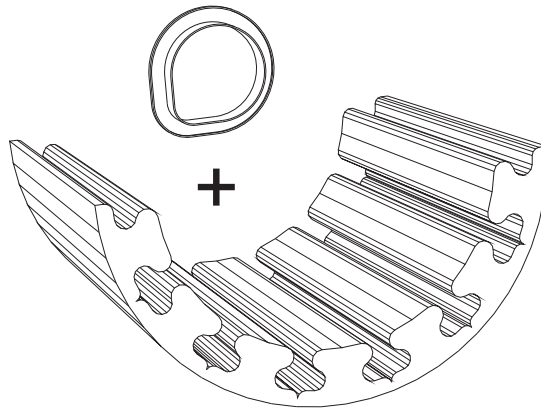

Features:

- * Kit includes KICK PAD® and PUNCH MASTER®.
- * Absorbent for the bass drum.
- * Manufactured in Acoustic Foam.
- * Efficiently reduces unwanted resonances.
- * For all bass drums ranging between 18" and 24".
- * Packaging: 1 unit.
- * Installation: to be placed inside the bass drum.
- * Use: at live and in studio.
- * Dimensions: 840 x 560 x 70 mm.
- * Colour: gray.

Colours:



To tune and get good sound out of a bass drum is sometimes a hard task. This instrument, which is an essential base of drum kits, needs to be treated once in a while.

The KICK PAD® was created to absorb unwanted harmonics which are out of tune with the bass drum note, thus making the beat clearer and more defined.

This accessory has some small markings in order for the musician to highlight small slices and adjust loudness as he/she pleases. It can be used in all sizes of bass drums.

ATP® PUNCH MASTER® is provided together with the KICK PAD®. This accessory allows you to fully control the bass drum head's vibration accentuating its punch and deepness at every beat. Its ultra light material and attractive design makes it look distinct and stylish. It also allows protection against tearing from cables or the microphone's tripod.

The KICK PAD® is cut alongside the curvature of the bass drum which prevents the foam cells from being closed, thus resulting in a more beneficial absorption.

This is a tool to be used either at live or in studio and is very useful for both the musician and the sound engineer.

KICK PAD Kit®



BABS®

Two sided self-standing absorbent panel



The BABS® is an acoustic barrier system which is ideal to have in your tracking room. It provides an outstanding acoustic division between each instrument or amplifier, thus optimising the separation between microphones during sound capturing. It is also the ideal solution for portable acoustic treatment. It can be used to improvise a rehearsal room, tracking room or control room that surrounds a monitoring system, etc.. It is provided with a foot for each module. It is easily mounted by placing it on your room's floor and adjusts to the intended situations. BLIND ABS's two faces are acoustically and aesthetically different. One of them absorbs more than the other one, also within different ranges of the sound spectrum, thus providing various options of loudness and modulation to your room. For different audition or sound capturing purposes, this versatile system allows to adapt the rooms' acoustic disturbances, thus becoming a very useful tool for your projects. It can be provided (optional) with a carrying bag for each two pieces, thus being very light and easy to carry.

Features:

- * Portable acoustic barrier.
- * Ideal to put around instruments, amplifiers and speakers.
- * Use: recording studios and mobile studios
- * Two acoustically different faces.
- * Installation: easy mounting on the base provided.
- * Packaging: 2 units.
- * Dimensions: 1170 x 550 x 90 mm.
- * Colour: black, gray, blue and beige

Foam colours:



Fabric colours:



Plastic colours:

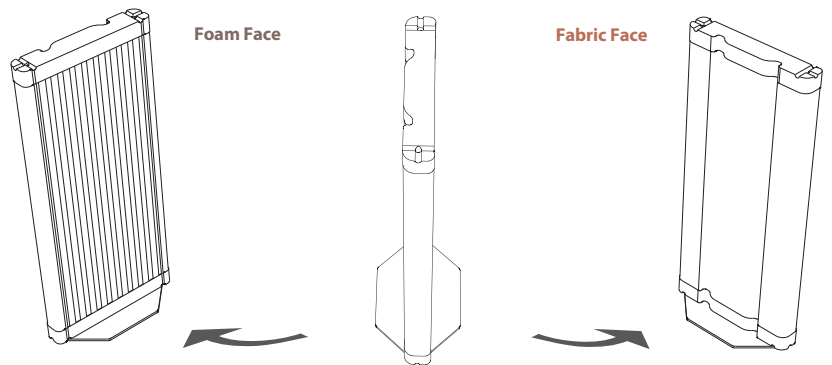

■ Absorption 1 (Foam) / ■ Absorption 2 (Fabric) Coefficient :

α_S	0.05	0.05	0.10	0.19	0.24	0.33	0.41	0.50	0.58	0.70	0.78	0.79	0.80	0.76	0.70	0.69	0.75	0.79	0.86	0.93	0.94	0.96	0.97	0.98	0.79	Foam
α_S	0.00	0.00	0.10	0.20	0.20	0.20	0.30	0.40	0.50	0.60	0.60	0.70	0.70	0.70	0.79	0.78	0.70	0.75	0.71	0.70	0.70	0.74	0.80	0.80	0.68	Fabric
Hz	50	63	80	100	125	160	200	250	315	400	500	630	800	1k	1.25k	1.6k	2k	2.5k	3.15k	4k	5k	6.3k	8k	10k	NRC	

ABSORPTION COEFFICIENT: Values in accordance with the standards: EN 20654, ASTM C423 and EN 11654.

□ Values are Non Standard Values.

ATP® accepts no responsibility for any printing errors. The colours shown are only a reference and some differences may occur due to production processes. Specifications can be modified without prior notice, if technical or commercial reasons so require.